

5 BUTTONS HANDLEBAR SWITCHGEAR CAN (SG5 CAN)

The SG5 CAN handlebar switchgear is designed specifically for Motorbike applications, that makes the product easy to use by the driver.

The CAN bus signal gives the status of each button and provides advanced diagnostics.

Custom configuration on request.



ELECTRICAL CHARACTERISTICS:

- Nominal current: 0.02 A
- Can Bus: 2.0A
- Baud Rate: 250K/500K/1Mbit Selectable by user
- Inversion Polarity Protection: Yes
- Mechanical Pushbuttons:
 - Available colors: White, Yellow, Orange, Red, Green, Blue, Grey, Black
- STD exit cable to the RIGHT, free wires, STD 500mm cable.
- Connector and cable length on request.

MECHANICAL CHARACTERISTICS:

- Black anodized aluminum case
- Laser marks on customer specifications
- Wiring with Raychem 55A wires and Raychem S1125 glue
- Fixing on Ø22mm handlebar
- Weight (without wires): ~ 80gr

➤ Dimensions:

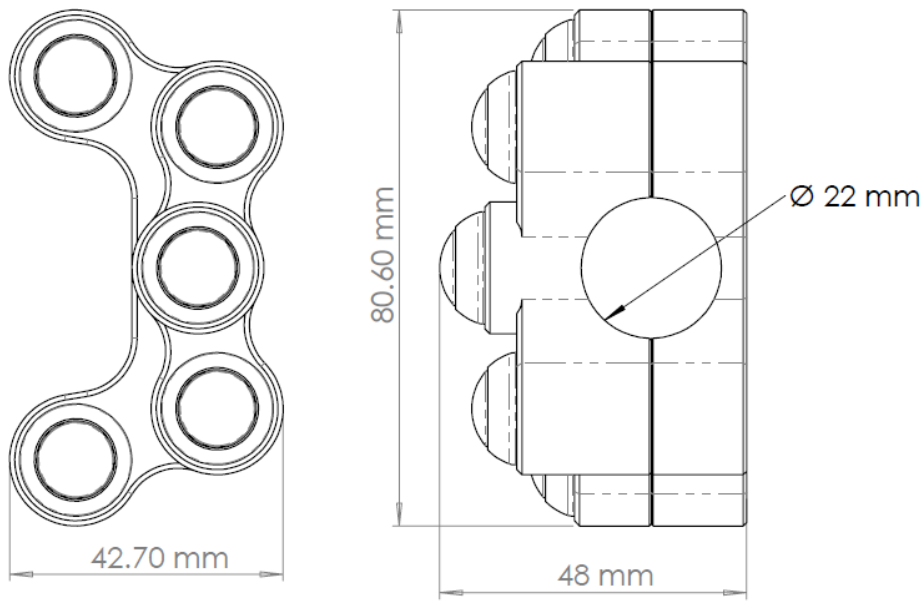

FIRMWARE CHARACTERISTICS:

- Change the button behavior (pushbutton or switch)
- Save the status of buttons configured as switch at power off
- Change CanID and BaudRate
- Firmware information and buttons configuration displayed
- CAN output: buttons status plus diagnostics (additional info on request)